

Benaroya Business Park - Sumner 4703 142nd Ave East Sumner, WA 98390

Building details

A. ZONING CLASSIFICATION:	LIGHT INDUSTRIAL (M-1)
B. LOT AREA	1,128,985 S.F. 25.917 ACRES
C. BUILDING AREA	440,682 S.F.
D. TRAILER PARKING PROVIDED	138 STALLS
E. DOCK DOORS PROVIDED	99 DOORS
F. DRIVE UP DOORS PROVIDED	4 DOORS

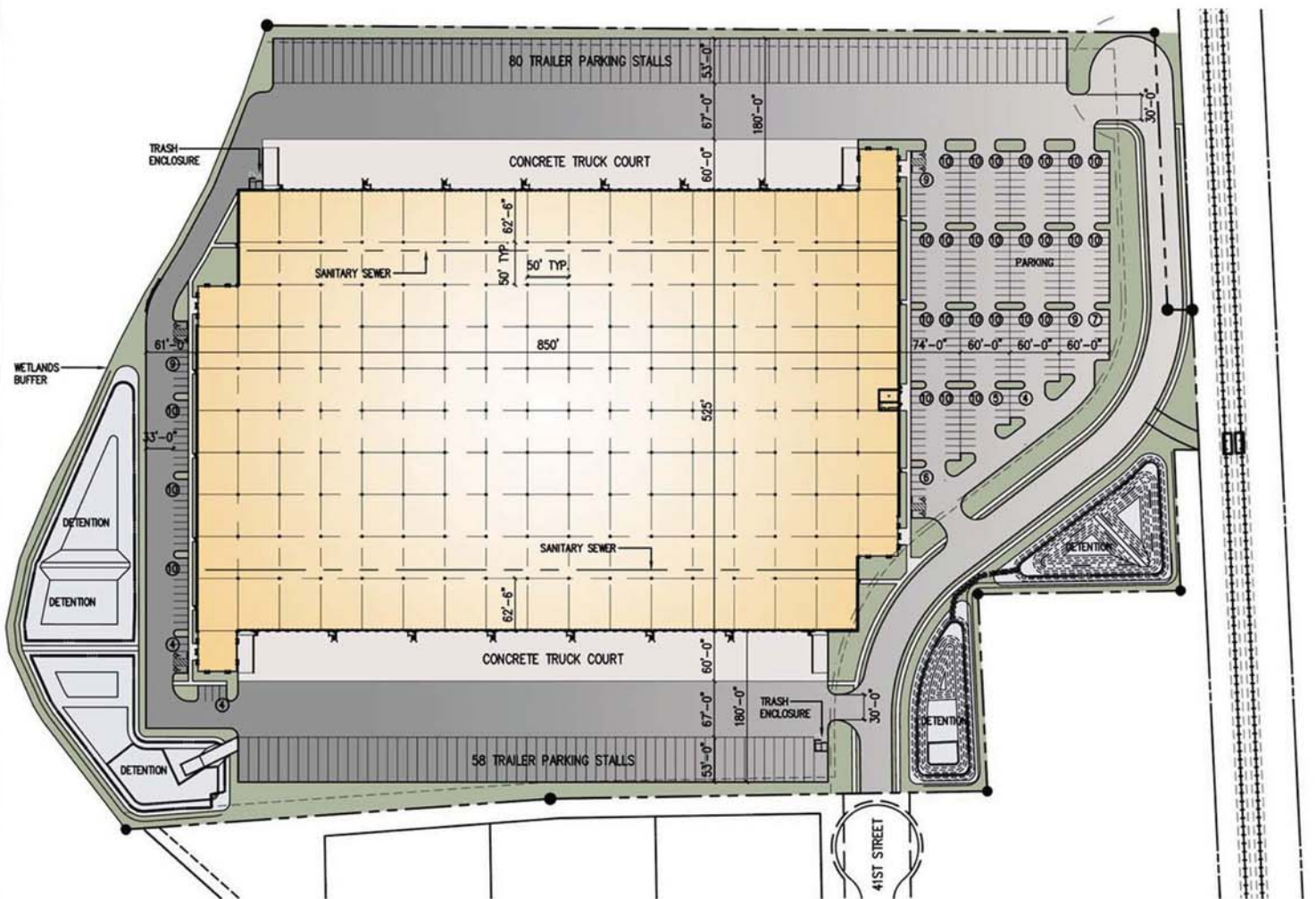

Site Plan